

Chocolate Suction Cups SPG

Suction area (Ø) 33 mm

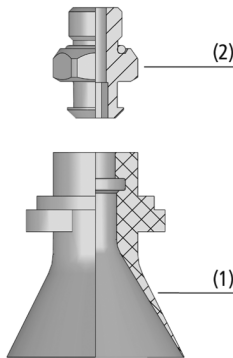

Chocolate Suction Cups SPG



System design Chocolate Suction Cups SPG



Chocolate suction cups SPG being used for handling chocolates

Suitability for industry specific applications

Application

- Bell-shaped suction cup for dynamic handling and packing of chocolates in combination with picker robots
- Direct handling of round, oval or square chocolates
- Handling of confectionery with structured surfaces or toppings
- Due to the use of FDA-compliant silicone, the contact with food is harmless
- Handling of round chocolates with maximum diameter of 35 mm and oval/square chocolates with maximum diagonal measurement of 30 mm

Design

- Suction cup (1) with extremely thin, soft sealing lip and tapered suction cup geometry
- Optimal sealing lip shape for handling workpieces with structured surfaces
- Use of one-piece insertable connection element (2), with G1/8" male or female thread, for changing the suction cup quickly
- Connection element with male thread has an integrated seal

Product highlights

- Extremely thin sealing lip optimized for decorated chocolates
- Conical shape safely encloses even square pralines; highest dynamics possible
- High nominal flow compensates for leakages due to highly structured chocolates
- Suction cup made of FDA compliant silicone suitable for direct food contact

Chocolate Suction Cups SPG

Suction area (Ø) 33 mm

Designation code Chocolate Suction Cups SPG

SPG	–	33	–	SI-45	–	SC040
1		2		3		4

1 – Abbreviated designation

Code	Version
SPG	Bell-shaped

2 – Suction area

Code	Diameter in mm
33	ø 33

3 – Material

Code	Material
SI-45	Silicone
SI-HD	Silicone

4 – Connection

Code	Connection
SC040	SC040

Suction cup SPG (elastomer part + connection element) is delivered assembled. The assembly consists of:

- Suction cup of type SPG – elastomer part
- Connection element of type SC – available with various threads

Ordering data Chocolate Suction Cups SPG

Type*	Part no.
SPG 33 SI-45 SC040	10.01.19.00002
SPG 33 SI-HD-65 SC040	10.01.19.00165

*Additional material specifications at beginning of the section "Vacuum Suction Cups"

Ordering data Accessories Chocolate Suction Cups SPG

Accessories	Part no.
Schmalz-Connector SC 040 G1/8-IG	10.01.06.02482
Schmalz-Connector SC 040 G1/8-AG	10.01.06.02490

Technical data Chocolate Suction Cups SPG

Type	Volume [cm³]	Hose inner diameter (recom.) d [mm]*	Nipple family
SPG 33 SI-45 SC040	8.1	4	SC 040
SPG 33 SI-HD-65 SC040	8.1	4	SC 040

*The suction force and operating vacuum are dependent on the geometry and surface characteristics of the chocolate. We recommend a maximum operating vacuum of -150 mbar.

Chocolate Suction Cups SPG

Suction area (\emptyset) 33 mm

Design data Chocolate Suction Cups SPG

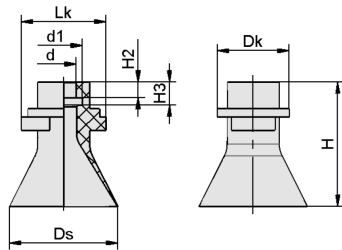

SPG

Chocolate Suction Cups SPG

Suction area (Ø) 33 mm

Design data Chocolate Suction Cups SPG

Type*	d [mm]	d1 [mm]	Dk [mm]	Ds [mm]	H [mm]	H2 [mm]	H3 [mm]	Lk [mm]
SPG 33 SI-45 SC040	7.3	11	21.5	32.1	38	4.8	7	25.5
SPG 33 SI-HD-65 SC040	7.3	11	21.5	32.1	38	4.8	7	25.5

*Acceptable dimensional tolerances for rubber parts concerning to DIN ISO 3302-1 E3